

OPEL MAULTIER HALF-TRACK

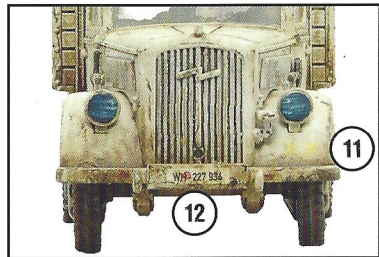

Winter camouflage,
1942-1943

- Army Painter Desert Yellow
- 820 Off White

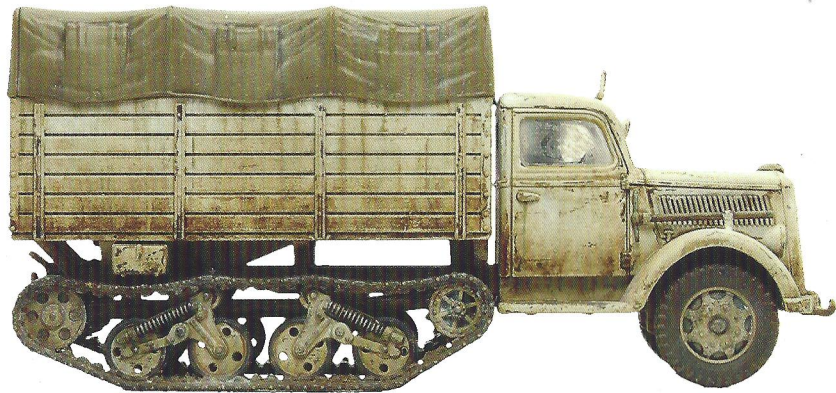
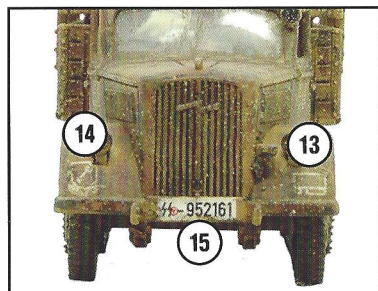
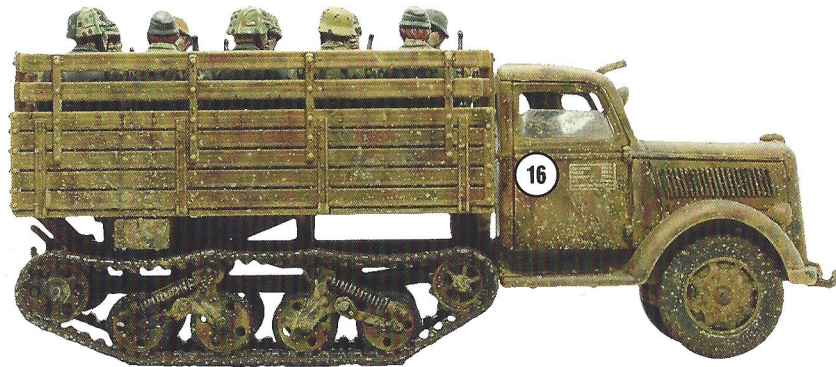

1st SS Panzer Division,
Hungary, March 1945

- Army Painter Desert Yellow
- 894 Camo Olive Green
- 984 Flat Brown

Component code: 4070100016



OPEL BLITZ TRUCK/ MAULTIER HALF-TRACK ASSEMBLY AND PAINTING GUIDE



With armoured half-tracks never being available in the numbers required, the Wehrmacht relied on horse-drawn carts and fleets of trucks to move their materiel around – the most iconic being the Opel Blitz. The Blitz is the classic German truck, seen in virtually every war film crammed with German soldiers and was used throughout the war on all fronts. It gave sterling service whether ferrying up much needed supplies to the front line, transporting troops to their posting or pulling artillery pieces into position.

The Maultier (Mule) version of the Blitz replaced the rear wheels with tracks from captured British Universal Carriers or obsolete Panzer I tanks. This gave the truck a fighting chance of crossing the

cloying mud and deep snows on the inhospitable Eastern Front.

This splendid plastic kit allows you to build either the wheeled Blitz or the halftracked Maultier. In addition you have options on canvas canopy, side panels, open canopy and even acetate windows should you choose to include them on your model! That's not all – we have also included a set of ten German soldiers, seated and ready to be ferried to the front lines...



ASSEMBLY GUIDE KEY

- | | | |
|----------------------------------|-------------------------------|-----------------------------------|
| A Assembly stage | Do Not Glue. | 22 Part number |
| A Previous assembly stage | Special assembly instructions | 3 Decal number |
| ? Optional assembly | Drill part | 987 Paint number (Vallejo) |

Follow this simple guide to building your German Opel Blitz truck or Maultier half-track transport.

Carefully remove each component from the frame with clippers or a craft knife. Trim off excess plastic before assembling. Test fit all parts before applying glue.

We recommend using polystyrene cement to assemble the kit, and to use this in a well-ventilated area.

Keep tools, glues, paints and small components away from children. Warlord Games recommend this kit for ages 14 and over.

DECAL APPLICATION GUIDE

- Apply a coat of gloss varnish to the areas that will receive the decal and allow this to dry fully.
- Cut out a decal from the sheet and soak it in luke warm water for 2-3 minutes.
- Once the design has started to separate from the backing paper, use tweezers or a wet paintbrush to slide the design into place on the model.
- Use a tissue to dab away any excess water from the model, and allow to dry.
- Apply a coat of matt varnish to seal the decal in place.

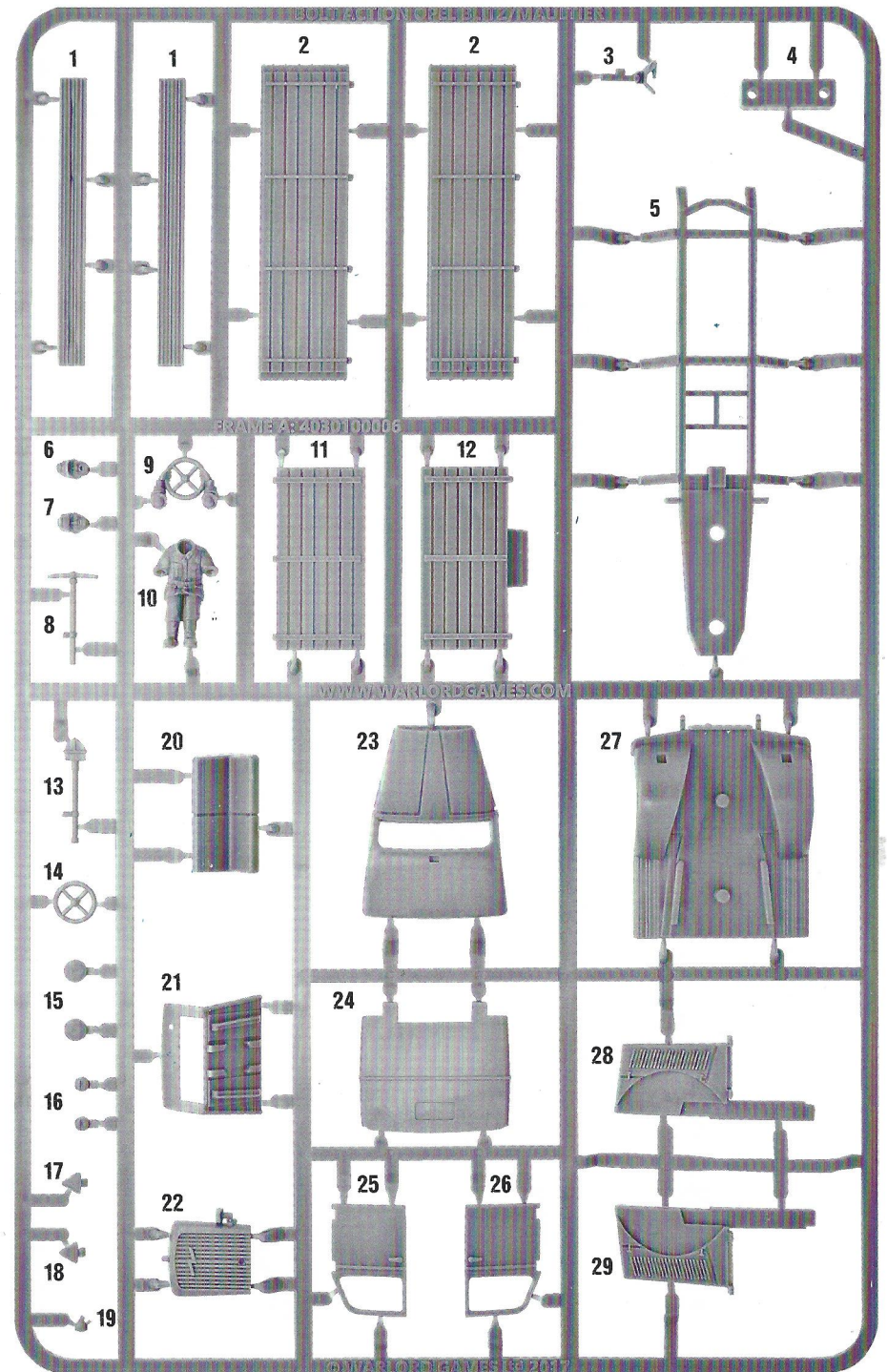
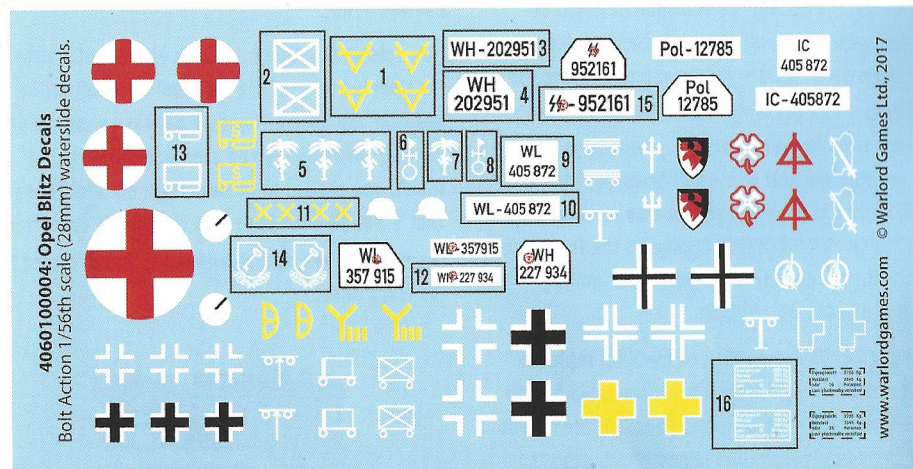

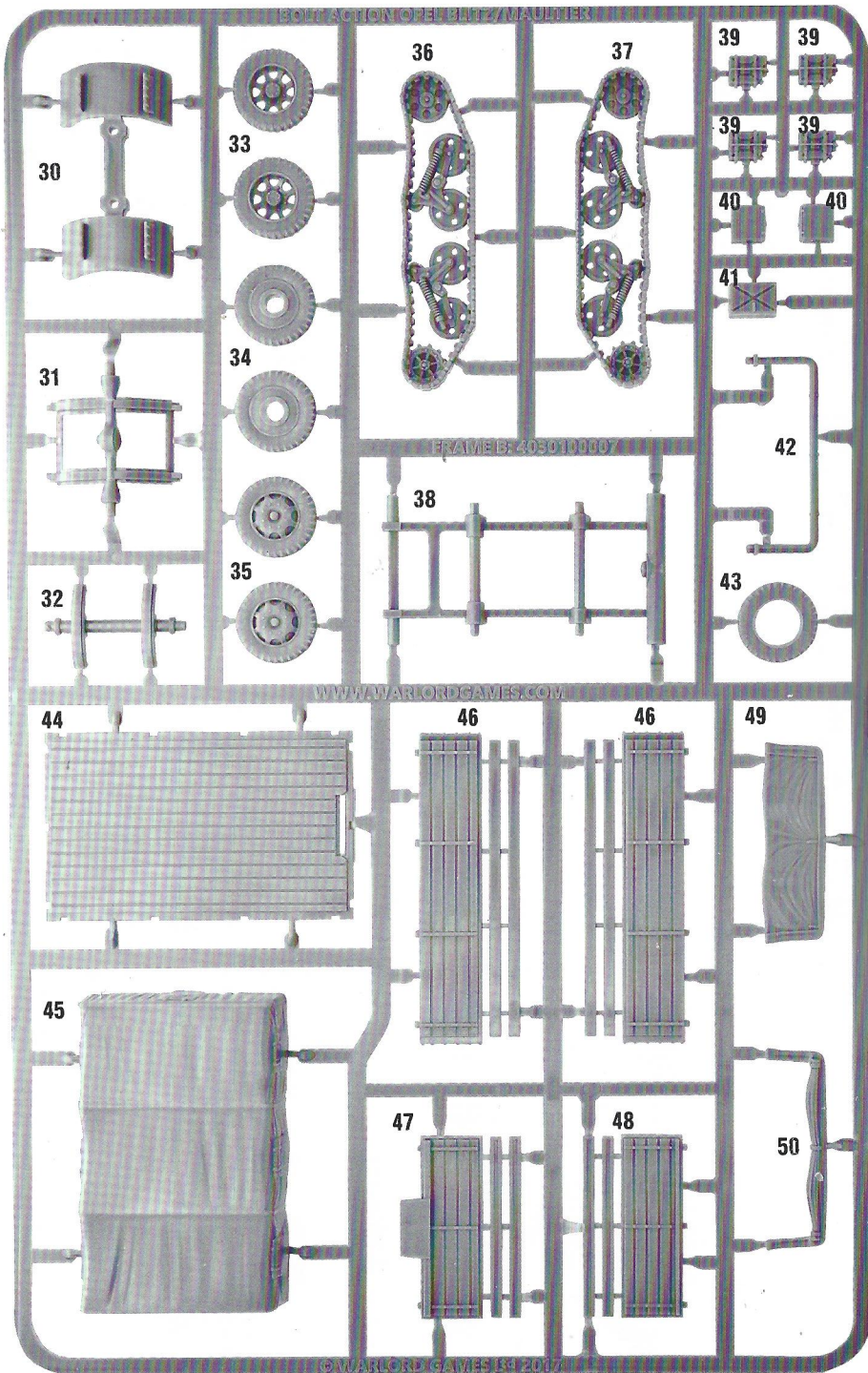

OPEL BLITZ AND OPEL MAULTIER

Follow stages A to B to build the cabin for both Opel Blitz and Opel Maultier.

A

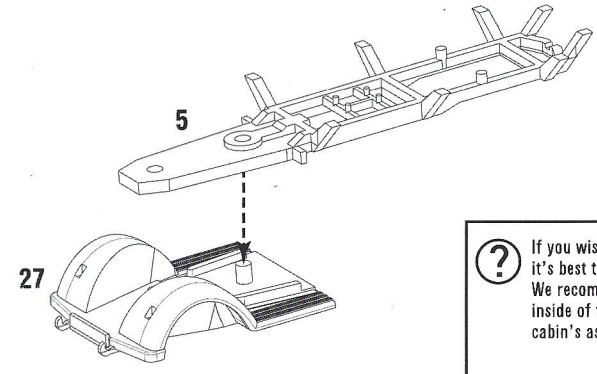

B

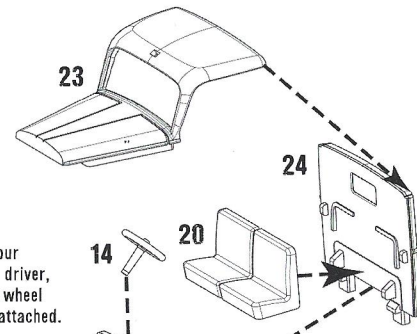

? If you prefer your vehicle without driver, use the driving wheel without hands attached.

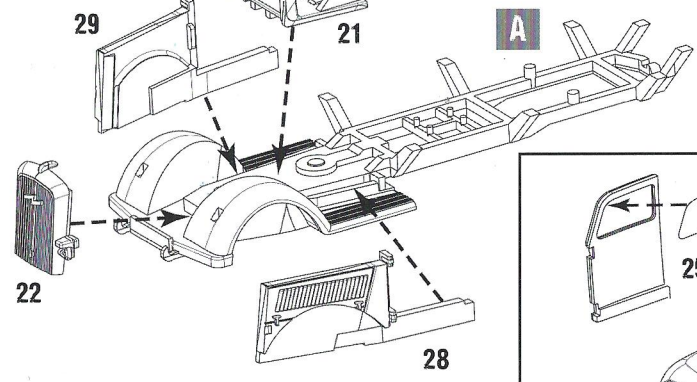

! For easiest assembly, start with sides of the cabin, followed by the grill. Then assemble the rest of the cabin. The top should be placed last - especially if you intend to include the driver.

? If you wish your vehicle to include a driver, it's best to assemble him at this stage. We recommend painting the driver and the inside of the cabin before finishing the cabin's assembly.

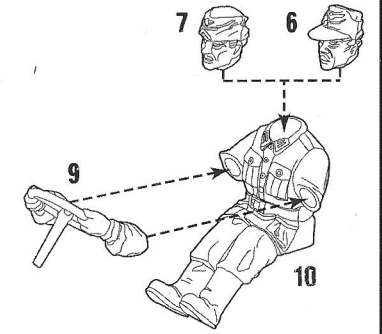

? To add the windscreen and windows, cut them out from the acetate sheet provided and glue them in place - from inside the doors and cabin's top - using polystyrene cement.

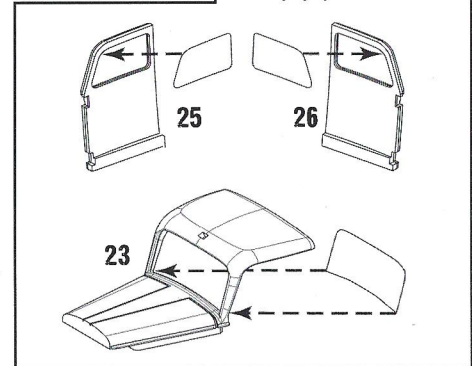

OPEL BLITZ

Follow the instructions below to build the wheeled chassis of Opel Blitz.

C

? Both doors can be assembled in open or closed position.

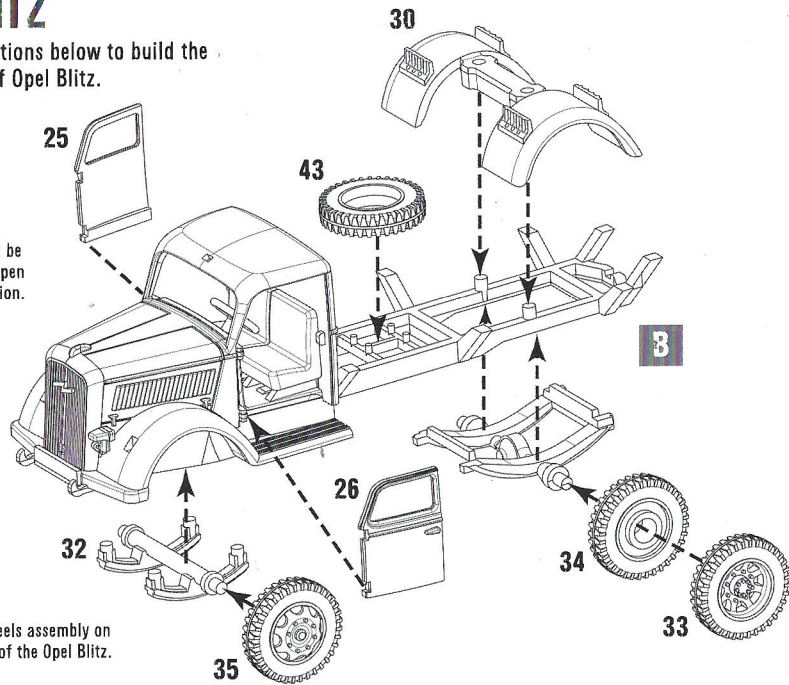

! Repeat the wheels assembly on the other side of the Opel Blitz.

OPEL MAULTIER

Follow the instructions below to build the half-tracked chassis of Opel Maultier.

D

? Both doors can be assembled in open or closed position.

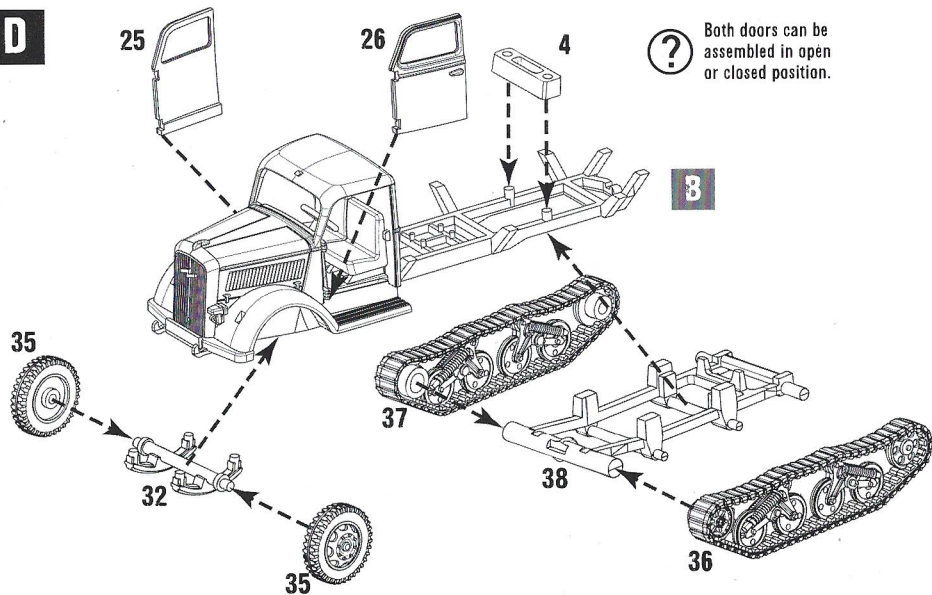

OPEL BLITZ AND OPEL MAULTIER

Follow the instructions below to build the back of the vehicle - both variants can be assembled with high or low side boards.

E

If you don't want to cover your vehicle with the canopy, you can add the folded-down canopy frame on top of your high side panels.

! Vehicle built with the high side panels can be assembled with or without the canopy.

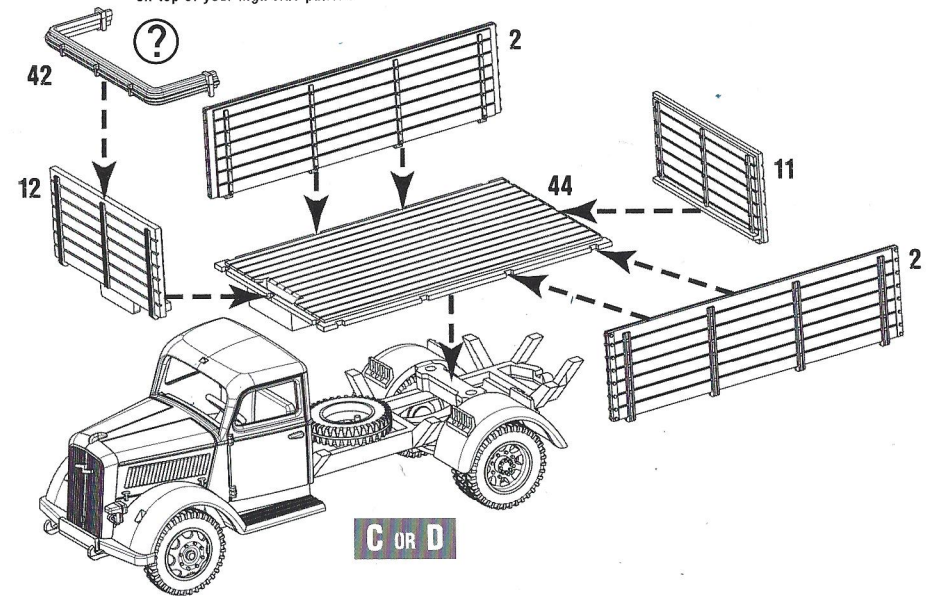

F

! Vehicle built with the low side panels cannot be assembled with the canopy.

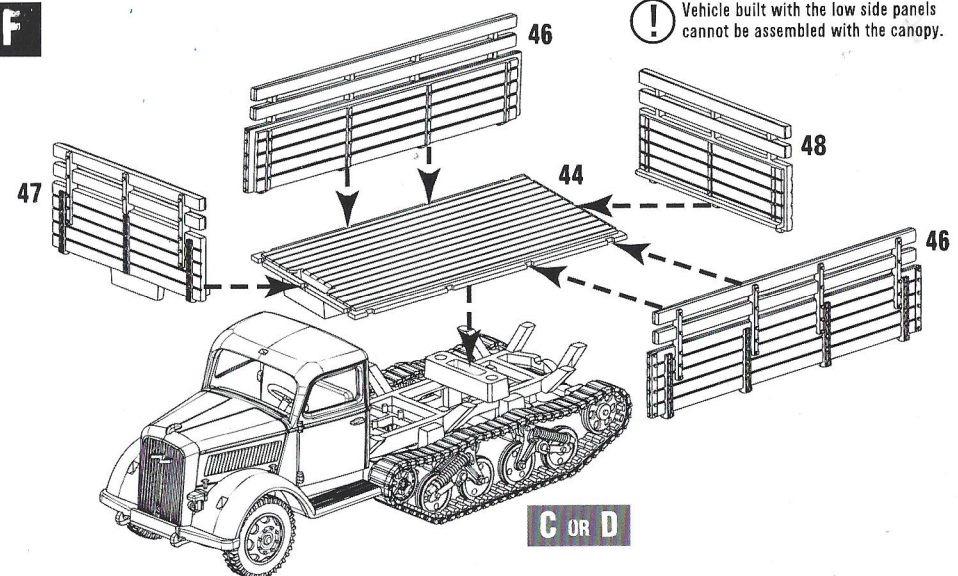

OPEL BLITZ

Follow the instructions below to build the underside of the chassis of Opel Blitz.

G

Place up to four jerry cans underneath the chassis.

Note that while not every Opel Blitz was equipped with an abundance of gasoline, it was a much more popular occurrence in Afrika Korps vehicles.

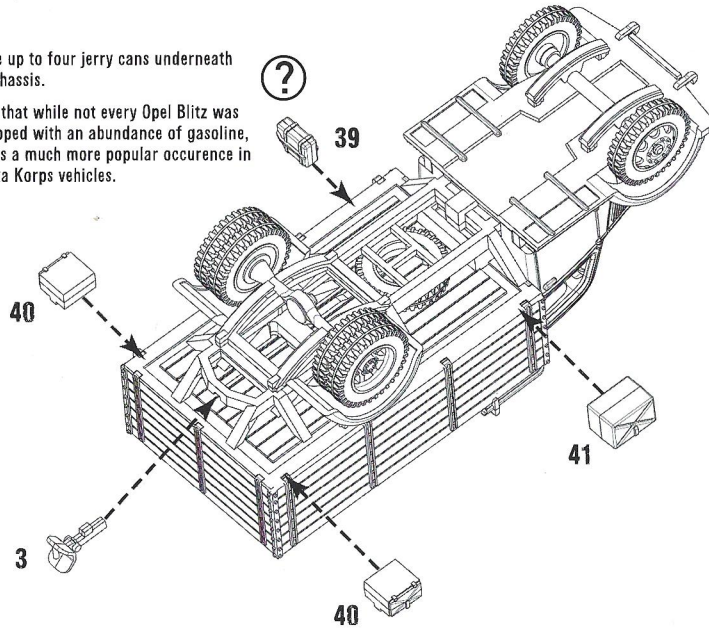

OPEL MAULTIER

Follow the instructions below to build the underside of the chassis of Opel Maultier.

H

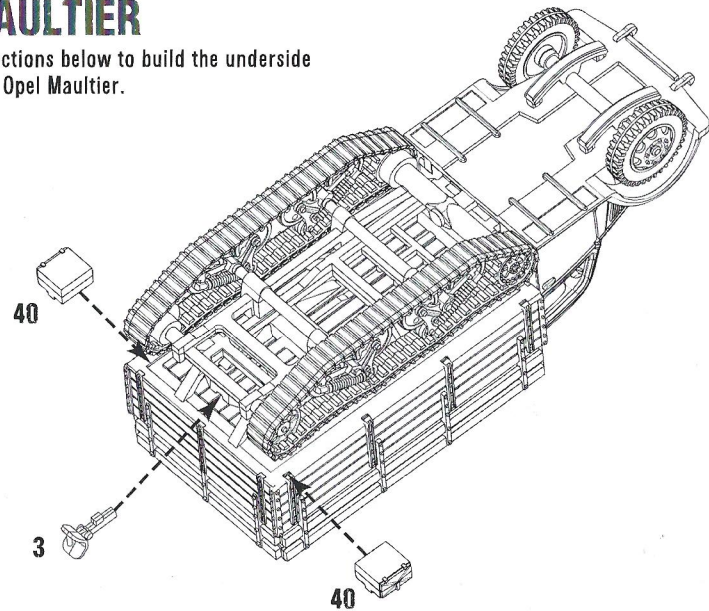

OPEL BLITZ AND OPEL MAULTIER

Follow the instructions below to complete you vehicle.

I

The triangle can be placed in upright or horizontal position.

You can equip your vehicle with a shovel and a pickaxe.

Choose between large or small front lamps.

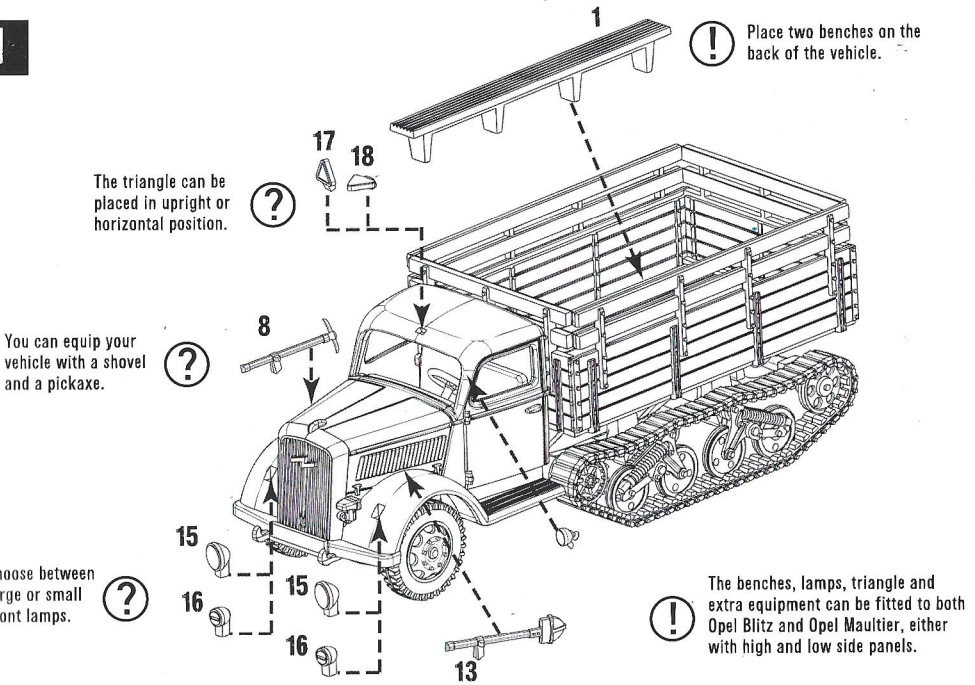

J

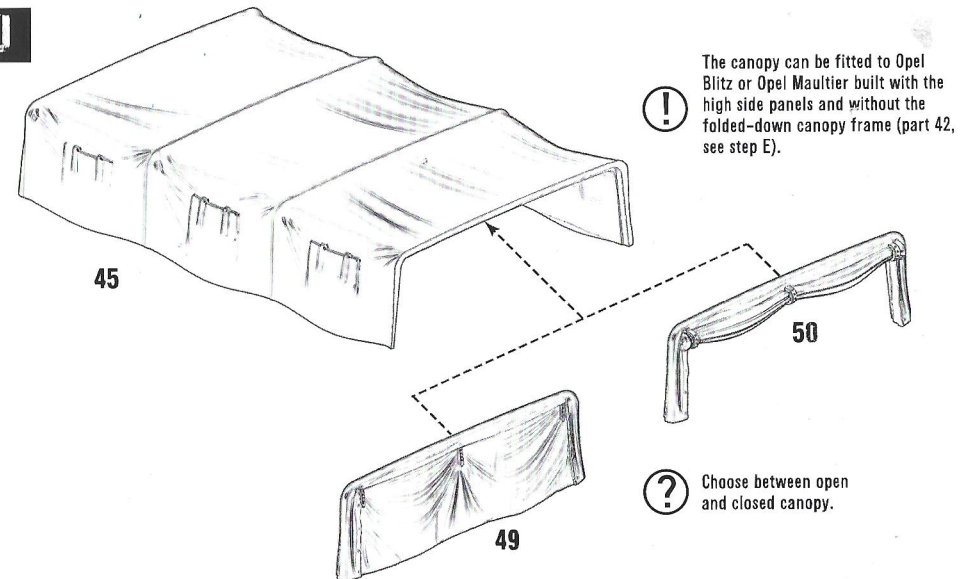

PASSENGERS

Assemble the passengers and place them on the benches of your vehicle.

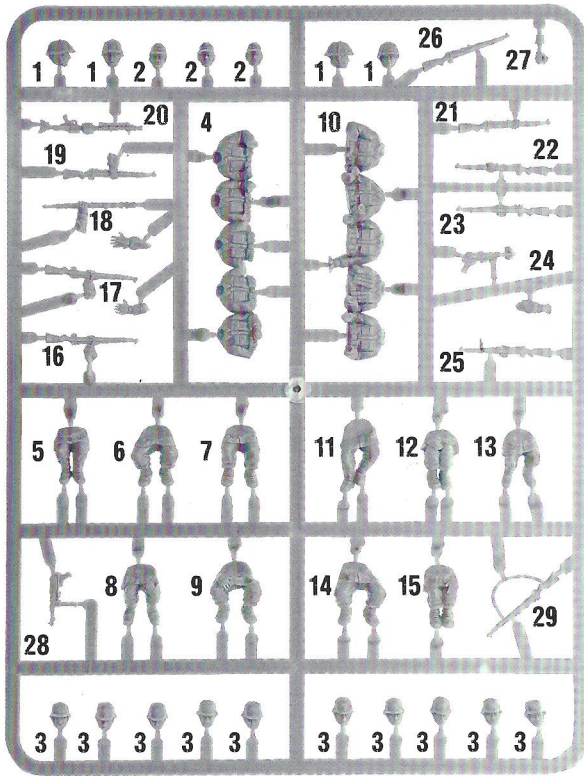

Please note that the legs, arms and weapons are best fitted as shown on the assembly diagram below.

Heads and extra equipment can be fitted as desired.

The passengers frame contains:

- 1: Head in covered stahlhelm (most suitable for Waffen-SS and Heer)
- 2: Head in field cap (suitable for all German infantry)
- 3: Head in stahlhelm (suitable for all German infantry)
- 4: Upper bodies A
- 5-9: Legs for bodies A
- 10: Upper bodies B
- 11-15: Legs for bodies B

Weapons and arms for bodies A:

- 16: Kar 98K rifle
- 17: Kar 98K rifle and left arm
- 18: Kar 98K rifle and left arm
- 19: Kar 98K rifle
- 20: MG42 light machine gun

Weapons and arms for bodies B:

- 21: Kar 98K rifle
- 22: Kar 98K rifle
- 23: Kar 98K rifle
- 24: MP40 sub-machine gun and right hand
- 25: Kar 98K rifle

Extra equipment:

- 26: Kar 98K rifle
- 27: Right hand with a grenade
- 28: MP40 sub-machine gun
- 29: Kar 98K rifle

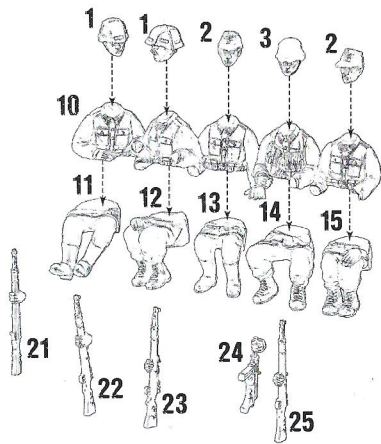
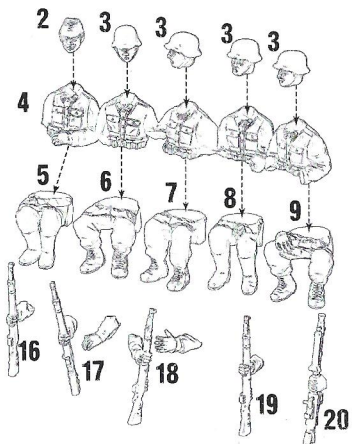

For clarity, right arm of the passenger with MP40 (part 24) has been already fitted in place on the diagram.

OPEL BLITZ TRUCK

18th Infantry Division,
Eastern Front, June 1941

603 Dunkelgrau Surface Primer

875 Beige Brown

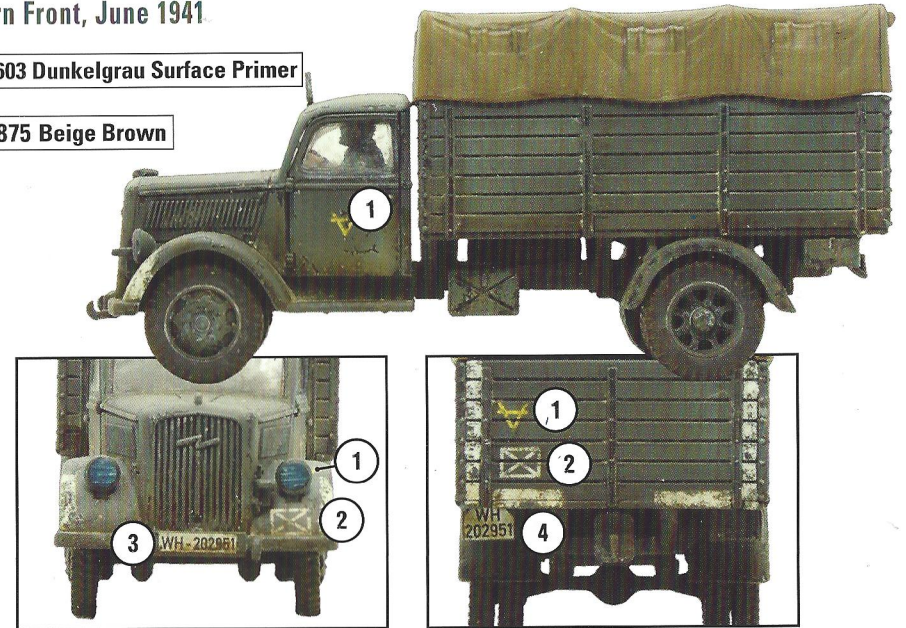

1st Battalion, 33rd AA Gun Regiment,
North Africa, 1942

Army Painter Desert Yellow

